

Combo Swab Self Sampling method



1

Wear disposable polygloves.



2

Open half of the collection kit(pouch) from the handle part.



3

Remove the reagent tube white cap and set it upright with the lid open.



4

2 times

While wearing your mask, blow your nose twice and cough twice.



5

! Do not touch swab tip when handling swab sample

Grab the handle of one of the two swabs and take it out.

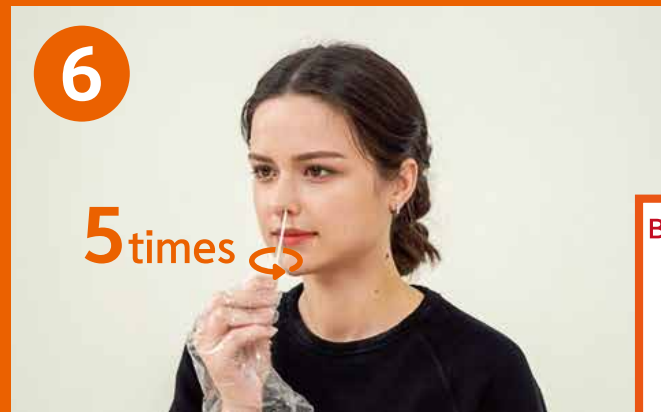

6

5 times

Rub the area 2~3 centimeters inside the nostrils in circular motion about 5 times.



7

○ It will be broken easily

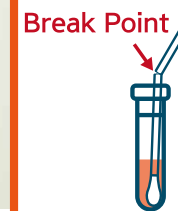

After inserting the swab into the reagent tube, carefully break the swab while leaning against the wall. Throw handle part away.



8

Gently close the tube cap.



9

! Do not touch swab tip when handling swab sample

Pull out the remaining swab by grabbing the handle.



10

Gently rub the gum in 4 places on the molar side and the lower part of the tongue sequentially.



11

Insert the swab into the tube and carefully break the swab again.



12

Both Swabs in one tube please

Close the reagent tube cab completely and place it in the tube rack. The end.

! Please note that there is a risk of puncture if excessive force is applied during the test.